

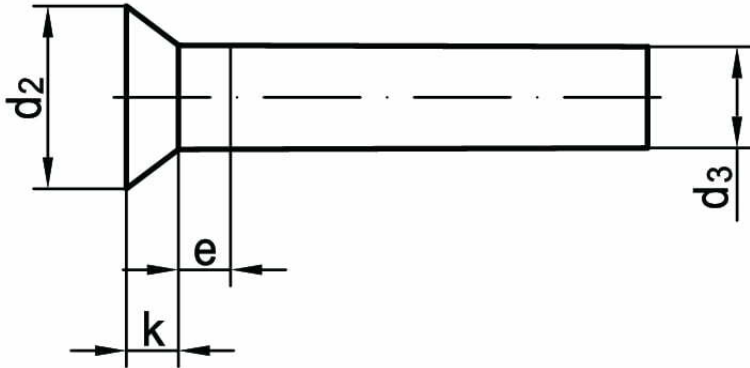

# Countersunk head rivet DIN 661

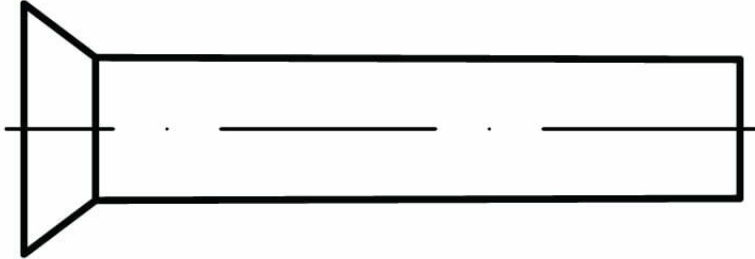

STANDARD	MATERIAL	CLASS	COATING
DIN 661 PN 82954 ISO 1050	steel A2 A4 brass copper aluminum		

$d_3$	M2	M2,5	M3	M4	M5	M6	M7	M8
$d_{3\min}$	1,87	2,37	2,87	3,87	4,82	5,82	6,82	7,76
$d_2$	3,5	4,4	5,2	7,0	8,8	10,5	12,2	14
$e_{\max}$	1	1,25	1,5	2	2,5	3	3,5	4
$k$	1	1,2	1,4	2	2,5	3	3,5	4